



NOTICE OF REGISTRATION

ALACHUA COUNTY REGISTRY OF PROTECTED PUBLIC PLACES

Registered Property: Jane B. Walker Memorial Park

PURPOSE:

This Notice of Registration is intended to notify the citizens of Alachua County that Jane B. Walker Park has been placed on the Alachua County Registry of Protected Public Places. This Registry has been created in accordance with the Protection of County-owned Lands Referendum, approved by the voters in 2008 which pertains to the protection of County-owned lands acquired or used for conservation, recreation, or cultural purposes. The referendum requires that a Registry will be created for the purpose of identifying fee-simple properties owned by Alachua County that are deemed to be worthy of the highest level of protection. When listed on the Registry, said properties may not be sold or converted to a use that will result in a loss of value for which the property was placed on the Registry, except by a majority vote of the electors in a County-wide election. Jane B. Walker Memorial Neighborhood Park (Jane B. Walker Park) was donated to Alachua County for use as a neighborhood park by the family of Jane B. Walker; specifically her husband Dr. Thomas J. Walker and her adult children, William T. Walker and Rose Ann Walker, to honor her memory. Jane B. Walker was the first woman elected to the Alachua County Board of County Commissioners serving from 1982 to 1986). While in office, she was known for her efforts to promote the conservation of ecologically important lands in Alachua County and continued to actively promote conservation until her passing in 2006. Alachua County has evaluated Jane B. Walker Park and has determined it is worthy of this level of protection.

GOALS:

Jane B. Walker Park will be developed as a neighborhood park in honor of Jane B. Walker. It will be used only for recreational activities that are user-oriented and may include the following types of amenities, play structures, picnic areas, open areas, recreation buildings, court games, hard courts, tennis courts, internal trails, shuffleboard, volley ball courts, natural areas, and landscaping.

LOCATION:

This 17.44-acre site is located in northwest Gainesville on the south side of side of N.W. 23rd Avenue at approximately N.W. 106 Street, in a developing part of Alachua County. It is adjacent to developments on the north, east and west sides and is approximately 2 miles southeast of Jonesville Park, and 1 mile north of the Alachua County Forever Robertson Conservation Easement. The Registered Property is legally described in Exhibit A and a general location map is provided in Exhibit B. A Boundary Survey is on file with Alachua County.

ACQUISITION HISTORY:

The 17.44-acre Jane B. Walker Park was donated to Alachua County on _____, 20__ by the family of Jane B. Walker; specifically her husband Dr. Thomas J. Walker and her adult children William T. Walker, and Rose Ann Walker, for use as a neighborhood park to honor Jane B. Walker's memory.

PUBLIC VALUES:

The primary public value of Jane B. Walker Park is as a neighborhood park that will help fulfill Alachua County's neighborhood park level of service, as well as contributing to Alachua County's green infrastructure and open space. As this area of the County continues to develop, the Jane B. Walker Park will become increasingly more valuable as greenspace in an urban matrix and provide residents with a safe and pleasurable recreational experience that is easily accessible to all ages.

ALLOWABLE USES:

Jane B. Walker Park will be used only for user-oriented recreation, environmental education and interpretation based activities, and related infrastructure. The following types of amenities may be included, play structures, picnic areas, open areas, recreation buildings, court games, hard courts, tennis courts, internal trails, shuffleboard, volley ball courts, natural areas, and landscaping.

To the greatest extent possible, improvements will be located to minimize impacts to natural resources, to avoid impacts to listed plant and animal species, and to avoid known archaeological sites.

Existing infrastructure on the property includes a barn, pole barn and well at the front of the property, in addition to a driveway and waterlines for the Walker homestead, located directly south of the Jane B. Walker Park at 10601 NW 23rd Avenue. Until the Jane B. Walker Park is developed the driveway and waterlines will continue to service the homestead. During the development of the Park, the County will move the driveway and possibly the waterlines to the 30 foot wide easement running along the eastern boundary of the Park described in Exhibit A.

PROHIBITED USES:

Uses that detract from or interfere with the property's use as a neighborhood park honoring Jane B. Walker. Specifically, any non-neighborhood park infrastructure or uses, and any non-recreational and non-interpretational signage are prohibited, except the above mentioned driveway and waterlines to the Walker homestead. All uses and development that do not enhance the use of the property as a neighborhood park are prohibited. Use of any existing improvements or improvements to be constructed on the property must not negatively impact the goal of developing a neighborhood park in honor of Jane B. Walker.

Notice of Registry
Alachua County Registry of Public Protected Places
Jane B. Walker Memorial Park

Alachua County, Florida
By its Board of County Commissioners

By:

Robert Hutchinson, Chair

ATTEST:

Date: _____

By: _____

J.K. "Jess" Irby, Esq.
Clerk of Court

Approved as to Form:

Sylvia Torres
County Attorney

EXHIBIT A.

LEGAL DESCRIPTION

Parcel ID:

Jane B. Walker Memorial Park

DONATION PARCEL

A PARCEL OF LAND SITUATED IN SECTION 31, TOWNSHIP 9 SOUTH, RANGE 19 EAST, ALACHUA COUNTY, FLORIDA; SAID PARCEL BEING ALL OF PARCEL 2 AND A PORTION OF PARCEL 3 OF THOSE LANDS DESCRIBED IN OFFICIAL RECORDS BOOK 3508, PAGE 1467 OF THE PUBLIC RECORDS OF ALACHUA COUNTY, FLORIDA; SAID PARCEL BEING MORE PARTICULARLY DESCRIBED AS FOLLOWS:

COMMENCE AT 1 INCH IRON PIPE (NO ID.) MARKING THE NORTHWEST CORNER OF SAID SECTION 31; THENCE SOUTH 00°27'11" EAST ALONG THE WEST LINE THEREOF, A DISTANCE OF 50.00 FEET TO A 4 INCH SQUARE SANDSTONE MONUMENT (NO ID.) ON THE SOUTH RIGHT-OF-WAY LINE OF NORTHWEST 23RD AVENUE (100' R/W) AND THE POINT OF BEGINNING; THENCE CONTINUE SOUTH 00°27'11" EAST ALONG THE WEST LINE OF SAID SECTION 31, A DISTANCE OF 1505.04 FEET TO A 1/2 INCH IRON ROD AND CAP (ALACHUA COUNTY); THENCE NORTH 89°38'38" EAST, A DISTANCE OF 399.32 FEET TO A 1/2 INCH IRON ROD AND CAP (ALACHUA COUNTY) LYING ON THE WEST BOUNDARY OF CARRIAGE WAY, AS PER PLAT THEREOF RECORDED IN PLAT BOOK 26, PAGES 62-64 OF SAID PUBLIC RECORDS; THENCE NORTH 00°26'19" WEST ALONG SAID WEST BOUNDARY, A DISTANCE OF 643.08 FEET TO THE NORTHWEST CORNER OF LOT 6 OF SAID CARRIAGE WAY; THENCE NORTH 89°20'22" EAST ALONG THE NORTH LINE OF SAID LOT 6, A DISTANCE OF 182.70 FEET TO A 4 INCH SQUARE CONCRETE MONUMENT (PSM5469); THENCE NORTH 00°26'19" WEST ALONG SAID WEST BOUNDARY, A DISTANCE OF 864.02 FEET TO A 4 INCH SQUARE CONCRETE MONUMENT (PSM5469) LYING ON SAID SOUTH RIGHT-OF-WAY LINE; THENCE SOUTH 89°20'45" WEST ALONG SAID SOUTH RIGHT-OF-WAY LINE, A DISTANCE OF 582.40 FEET TO THE POINT OF BEGINNING; ALL BEING AND LYING IN SECTION 31, TOWNSHIP 9 SOUTH, RANGE 19 EAST, ALACHUA COUNTY, FLORIDA; CONTAINING 17.44 ACRES MORE OR LESS.



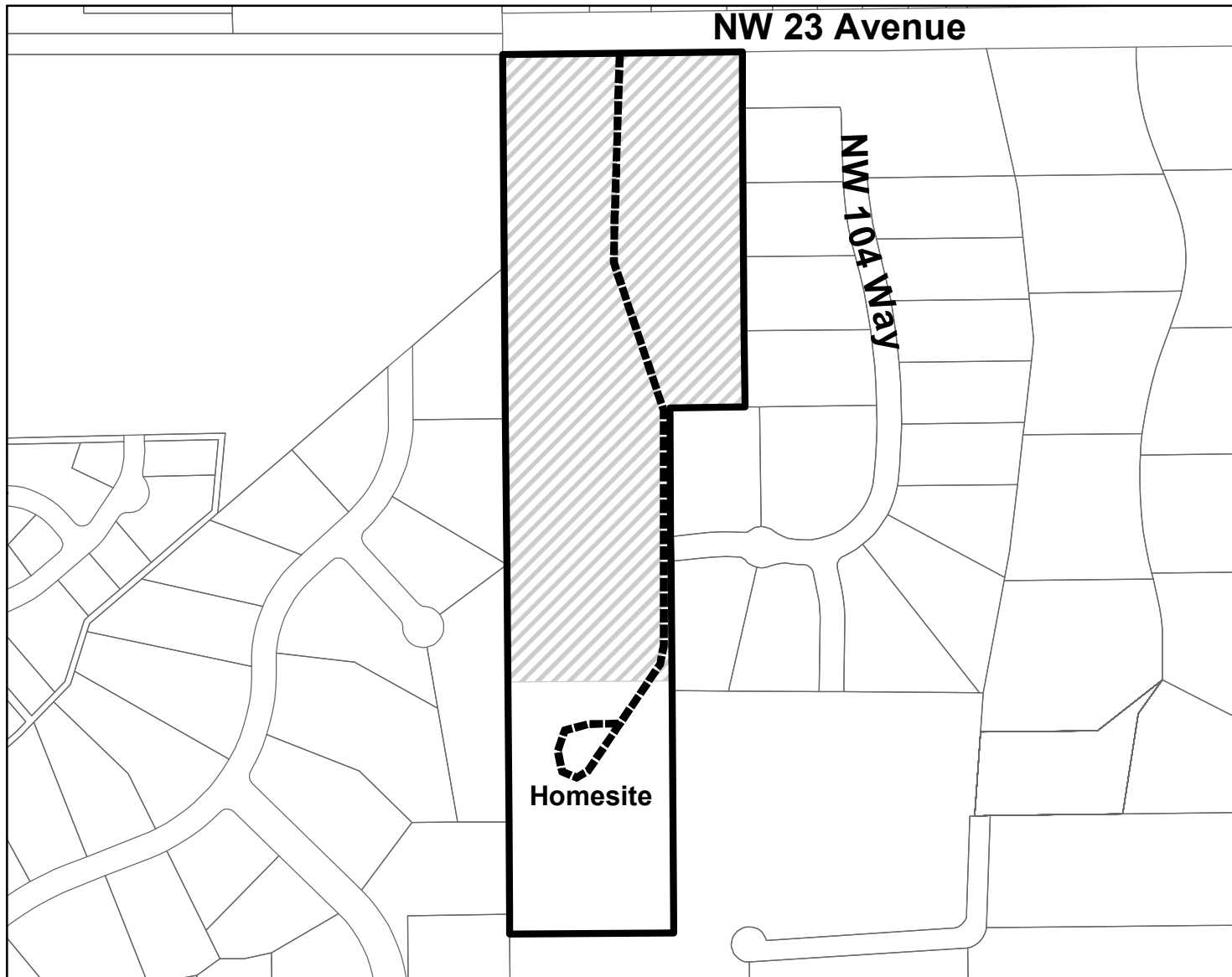

SUBJECT TO A 10 FOOT WIDE EASEMENT FOR PUBLIC UTILITIES AS RECORDED IN OFFICIAL RECORDS BOOK 733, PAGE 11 OF THE PUBLIC RECORDS OF ALACHUA COUNTY.

SUBJECT TO AN EASEMENT FOR INGRESS AND EGRESS OVER, UNDER AND ACROSS A 30 FEET WIDE STRIP OF LAND LYING WEST OF AND PARALLEL WITH THE WESTERLY BOUNDARY OF CARRIAGE WAY AND NORTH OF AND PARALLEL WITH THE NORTHERLY BOUNDARY OF LOT 6 OF CARRIAGE WAY, AS PER PLAT THEREOF RECORDED IN PLAT BOOK 26, PAGES 62-64 OF THE PUBLIC RECORDS OF ALACHUA COUNTY, FLORIDA

EXHIBIT B - Jane B. Walker Memorial Park



Legend

-  Park Property (17.44 ac.)
-  Parent Tract (23.25 ac.)
-  Existing_Driveway
-  ACPA Parcels

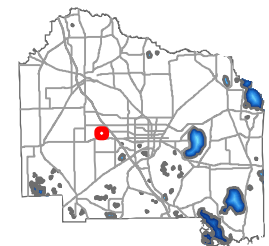

0 175 350 700 1,050 1,400 Feet

DISCLAIMER: This map and the spatial data it contains are made available as a public service, to be used for reference purposes only. The Alachua County Environmental Protection Department provides this information AS IS without warranty of any kind. The quality of the data is dependent on the various sources from which each data layer is obtained.